

küchenwohntrends

fachmesse für küche essen wohnen

EXHIBITION PLANNINGS

nolte[®]
KÜCHEN



NOLTE BY NATURE

Welcome to the küchenwohntrends 2023 trade fair

This year, everything at Nolte is focused on the most innovative product in the world: nature.

From mystical forests and picturesque lakes to primordial mountain ranges, our natural environment offers the loveliest of colours and impressive textures that provide an endless source of information and have notably inspired our product innovations.

Nolte by nature – discover all the innovations and the latest kitchen, dining and home living trends for 2023.

Inspired by nature.

Developed by Nolte Küchen.

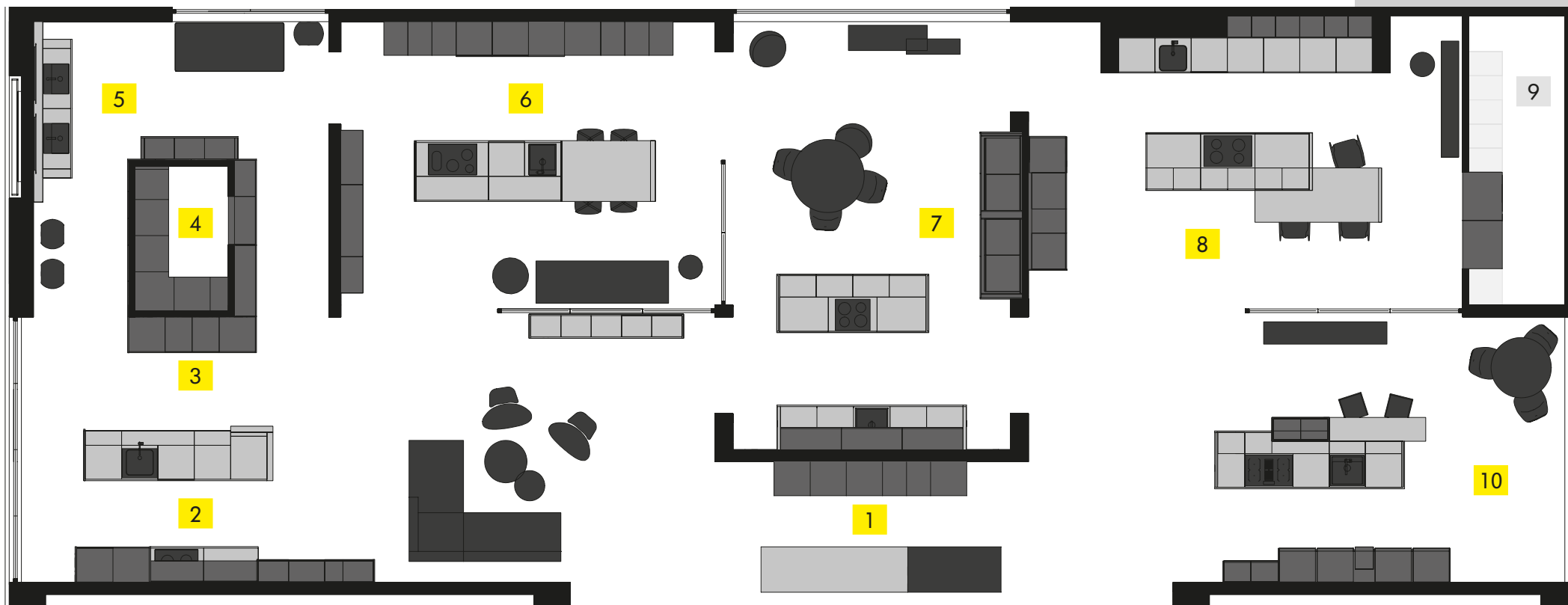

Exhibition stand at küchenwohntrends 2023 Hall 10 | Stand G51

- | | | |
|--|---|---|
| 1 neoLODGE Blackened oak | 4 Utility room
PLUS Platinum grey soft mat | 7 neoSLATE exclusive front in Slate black rosato
SOFT LACK Henna red soft mat |
| 2 SOFT LACK Black green soft mat
FRAME LACK Black green soft mat | 5 Nolte SPA bathroom
PLUS Black soft mat
LEGNO Oak sepia | 8 neoLODGE Blackened oak
neoPURE Metal bronze |
| 3 Hallway/office
LEGNO Oak sepia | 6 nolteneo
LUGANO LACK Magma soft mat | 10 Express Küchen
MOON Light grey mat
MOON Black mat |





ANYTHING. EXCEPT ORDINARY.

Clean, purist lines. Exclusive fronts and fascinating details. Colours and materials that enter a harmonious dialogue and are in balance with practical design. A nolteneo kitchen makes spaces into a statement, and is an expression of individuality and freedom of choice. From a wide range of planning options to exclusive fronts and design elements, nolteneo opens up entirely new dimensions in individualisation. Besides the elements that are featured in every nolteneo kitchen, there's also an extensive choice of exceptional models and designer elements.

Discover nolteneo
in the displays

1 6 7 8

nolteneo





nolte[®]
KÜCHEN

LIVING
UTILITY
ROOM

NOLTE LIVING – MORE THAN KITCHENS

For over 60 years, the Nolte name has stood for top-quality kitchens, made in Germany. And since life today is shifting more and more to the kitchen, Nolte also offers home furniture that provides a smooth transition from the kitchen to the living space, and vice versa. Whether it's a sideboard, TV cabinet, or furniture with optional integrated home office – the uniform appearance between the living space and kitchen flows to ensure a harmoniously matched style. With Nolte LIVING you can also design many more living spaces. An extensive range guarantees variety in all spaces.

The utility room used to be an integral part of every household. Then it tended to go out of fashion, mainly for reasons of space – after all, living space has become increasingly expensive. But this is precisely why it is being rediscovered – and completely redefined: a utility room not only perfectly complements modern, design-focused kitchens, it gives the entire household a clearer and more practically organised structure.

Discover Nolte LIVING
in the displays

3 4

This is where
you can discover
more about
NOLTE LIVING





MOMENTS OF WELLNESS

It isn't just in kitchens and living spaces that Nolte is always first choice. Now there is the youngest member of the family Nolte SPA – exquisitely designed and manufactured in top quality at Nolte Küchen, Germany's favourite kitchen brand. Here, above all, it's the details that make the difference: From attractive decors also on the inside of cabinets, to MatrixArt, the handleless bathroom.

Discover Nolte SPA
in the display

5

[®]
nolte SPA

This is where
you can discover
more about
NOLTE SPA





Sleek, elegant

1 Well-being with exclusivity: **neoLODGE** is a sophisticated world in itself. The combination of sleek lines with classy colours and materials is complemented by intelligent detail solutions such as side-fitted ovens or the elegant display units in manganese bronze.

2 Island solution with shadow reveal

3 900-mm carcass with inset plinth panel at the side

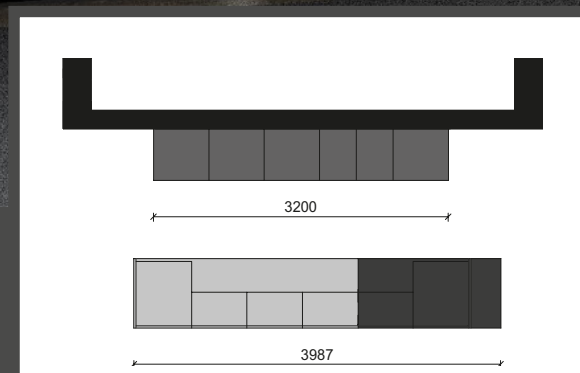

Carcass: GTD – graphite

Panels: FE5 – veneer, blackened oak, 12 mm thick
LMZ – lacquer, black, 12 mm thick

Drawer: **neoBOX**

1

note**neo**

neoLODGE

Blackened oak



Timeless elegance

- 1** The new black green soft mat colour shade extends the mat lacquer concept and is hence available for all five front ranges.
- 2** The particular feature of this kitchen is the combination of FRAME LACK framed front and understated, frameless SOFT LACK.
- 3** The counter element (100 mm thick) in concrete white makes a stunning contrast while also serving as a room divider.

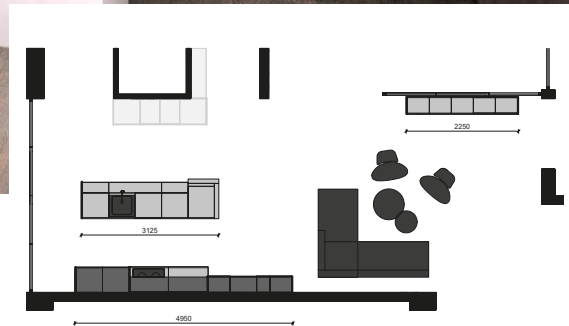

Carcase:	GTD – graphite
Visible sides:	LM8 – lacquer, black green soft mat
Panels:	LM8 – lacquer, black green soft mat, 25 mm thick
Worktop:	C30 – white concrete, 25 mm thick
Handle:	850
Electrical appliances:	Siemens
Drawer:	PremiumLINE Box

SOFT LACK

Black green
soft mat

FRAME LACK

Black green
soft mat

MATRIX900
by nolte KÜCHEN



Hallway and homeworking space in one

- 1 The hallway offers endless storage space.
Oak sepia wood decor is used to create a picture of overall harmony.
- 2 Integrated coat rack with seat
- 3 Homeworking solution
- 4 Transition to the hidden utility room

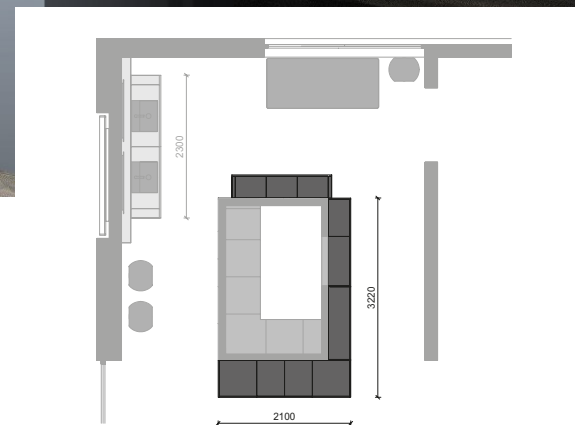

Carcase: GTD – graphite
 Panels: FES – veneer, oak sepia, 16 mm thick
 Drawer: PremiumLINE Box

3

nolte
KÜCHEN

LIVING



LEGNO

Oak sepia

4

nolte
KÜCHEN

UTILITY ROOM



Perfectly arranged and stored away

- 1 The utility room leaves nothing to be desired.
- 2 Laundry sorting unit
- 3 Ergonomically raised washing machine

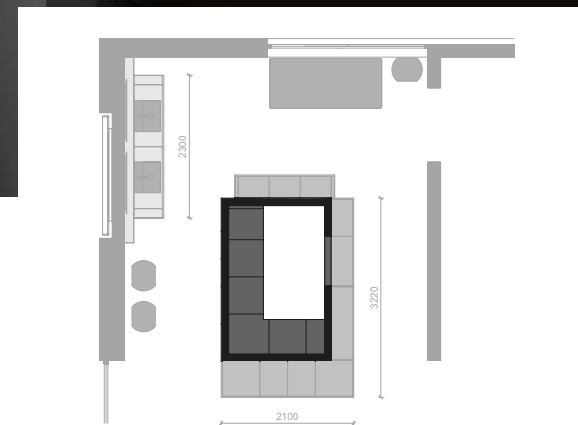

Carcase: PGD – platinum grey
 Handle: 561
 Electrical appliances: Samsung
 Drawer: PremiumLINE Box

PLUS
 Platinum grey
 soft mat



Timeless and simple

- 1** This bathroom idea impresses. The understated PLUS laminate front in black harmonises perfectly with the washstand top. Anti-fingerprint finish makes the front particularly low-maintenance and forgiving.
- 2** Two function mirrors with full-circle LED light surround.
- 3** Only 15 cm wide, the MatrixART end base unit cleverly combines a handleless open look with additional storage space.

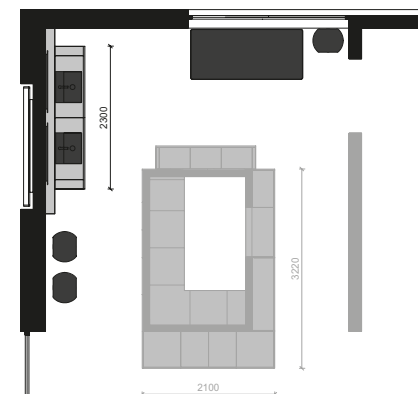

Carcase:	GTD – graphite
Panels:	SAS – laminate AFP, black soft mat, 25 mm thick
Washstand top:	U 23 – black PRO, 25 mm thick
Handle:	591 MatrixArt black
Drawer:	PremiumLINE Box



Country style a modern touch

- 1** LUGANO LACK – framed front in real ash which, as a new substrate, extends our mat lacquer concept with 18 colours.
- 2** Display units with narrow aluminium frames, black tinted glass and side lighting conjure a homely ambience.
- 3** HRV open shelf units with lighting
- 4** Worktop and end support panel in a thickness of 80 mm (to be provided on site)

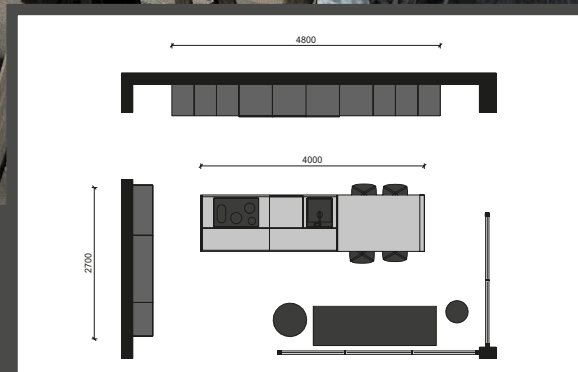

Carcase:	SHD – sahara
Visible sides:	ER9 – lacquer, reproduction ash, magma soft mat
Worktop:	TOP granite, black forest satin (to be provided on site)
Electrical appliances:	Samsung and Siemens
Drawer:	neoBOX with LED lighting
Handle:	MatrixZERO



Statement: bold and compelling

- 1** The exclusive **neoSLATE** front in slate black rosato in combination with **SOFT LACK** in henna red soft mat produces an exciting symbiosis.
- 2** nolte**neo** plinth support on island and sink row
- 3** **neoSLATE** side cladding on island and sink row
- 4** Quartz grey carcase with visible sides in henna red

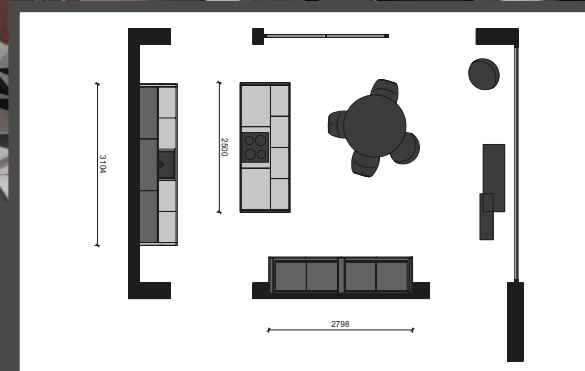

Carcase:	QGD – quartz grey
Visible sides:	LM5 – lacquer, henna red soft mat
Panels:	LM5 – lacquer, henna red soft mat, 25 mm thick
Worktop:	G67 – black real glass, 12 mm thick
Handle:	621
Electrical appliances:	Siemens
Drawer:	neoBOX with LED lighting

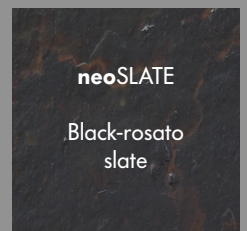

neoSLATE

Black-rosato
slate



SOFT LACK

Henna red
soft mat



ITALIAN AESTHETIC

- 1 Well-being with exclusivity: **neoLODGE** is a sophisticated world in itself. The combination of sleek lines with classy colours and materials is complemented by intelligent detail solutions such as side-fitted ovens or the elegant display units in manganese bronze.
- 2 MatrixArt ONE with a finger pull at top and Push-To-Open at the bottom
- 3 Integrated dining area
- 4 The display units in manganese bronze with tinted glass and uninterrupted glass door look particularly elegant in this kitchen.

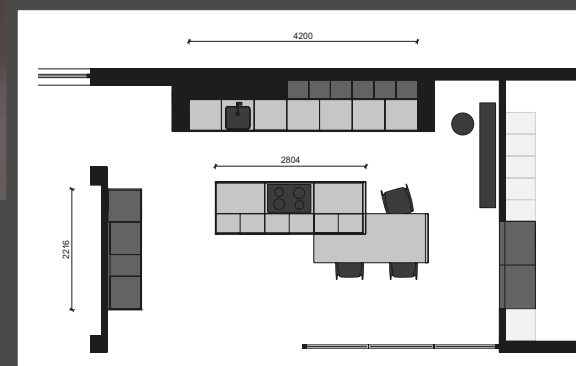

Carcase:	GTD – graphite
Panels:	LM9 – lacquer, magma soft mat, 12 mm thick
Worktop:	to be provided on site
Handle:	MatrixArt ONE
Electrical appliances:	Samsung
Drawer:	neoBOX with LED lighting

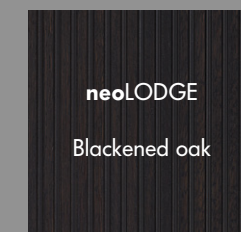



Stunning design meets functionality

- 1 Ergonomically built-in oven
- 2 The display units give this kitchen an elegant look.
- 3 Recess panelling with motif

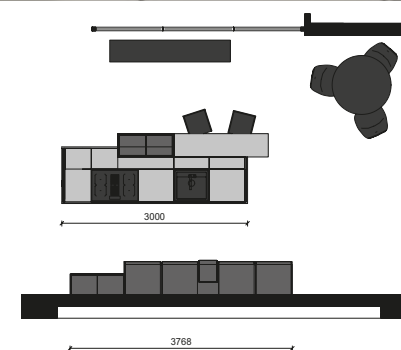

Carcase:	K39 – light grey
Panels:	K29 – black, 16 mm thick
Worktop:	P47 – natural stone, dark, 25 mm thick
Handle:	701 Systemline black
Electrical appliances:	Constructa
Drawer:	Advantage

MOON

Light grey
mat

MOON

Black
mat

” We don't see sustainability as a trend. For us, sustainability means treating people, the environment and nature with respect. **“**

Sustainability has always been a part of Nolte Küchen's corporate policy. Social responsibility, protecting the environment and conserving natural resources are always taken into account in our daily actions and thoughts in order to achieve lasting improvements for people and nature.

OUR COMMITMENT TO ...



THE COMPANY

As a matter of good corporate governance and the associated values, we have established resilient structures, processes and partnerships over a period of many years. High quality; modern aesthetics, sustainability and an attractive price-performance ratio are the factors that are always taken into account in our product range. So, for instance, over 99% of the woods we use complies with the principles of sustainable wood criteria.



THE PEOPLE

Our members of staff are particularly close to our heart. Their dedication, knowledge, experience and curiosity are what define us as Nolte Küchen. For this reason, we are pleased to assist our staff in furthering their development – both on the work side through basic and further training as well as on a private level by respecting and enhancing their work-life balance.



THE ENVIRONMENT

As a company, we have made it our aim to maintain a responsible and sustainable use of natural resources. Thanks to our effective climate management, we are able to manufacture our products in a climate-neutral manner at our two operating bases in Löhne and Melle. The main fuel sources at Nolte Küchen are certified green electricity and our boilers, which operate with offcut wood from production.



THE SOCIETY

Ever since Nolte Küchen was first founded, we have cultivated close ties with the region, and we actively foster its well-being and growth. Social commitment is a tradition for us, and we have placed great emphasis on it from the very first day. We help people and regions in emergency situations, such as educational institutions, associations and foundations that are involved in child protection. Our credo: support is given where support is needed.

Discover here the
**NOLTE
SUSTAINABILITY
REPORT**



The kitchen is the room of rooms.
We probably *live* more,
and more *intensively*,
here than anywhere else in the home.
It is the place where
we meet, where we encounter others.
As family or friends.
As a couple.
We *cook, eat* and *enjoy* ourselves
in the kitchen. And sometimes we have
all the time in the world as we do so.
We argue. And *make up again*.
We read, write, send emails, post messages.
And maybe philosophise a little.
And – quite secretly – the kitchen sets
the rhythm of our day.
Good morning. Then midday. Then evening.
And sometimes night ...
Which is *why we love* the kitchen.

Living in the kitchen. nolte

Follow us



nolte[®]
KÜCHEN